

**Prefabricated lifting station for clean and grey water in compliance with EN 12050-2 standard**

**MIDIBOX Series**



**MARKET SECTORS**

DOMESTIC.

**APPLICATIONS**

- Suitable for delivering clean and grey water to main sewer lines located at a higher level, or where gravity drainage is not possible.

**SPECIFICATIONS**

- The station is equipped with:
  - Polyethylene **basin** with a capacity of 110 litres, equipped with a threaded cover.
  - **Cable glands** for power supply cables (and floats).
  - Rp 1 1/4 or Rp 1 1/2 **delivery pipes** with fast connection and ring nut for easy disassembly of the pump.
  - **3 fast connections**:  
1 x DN110 for inlet,  
1 x DN50 for ventilation and  
1 x DN65 for cable connection.
  - **1 x DN50** fast connection for the manual pump.
  - **DOC or DOMO 7 submersible pump**, vortex or channel impeller type.
  - **QDR control panel** for three-phase versions.
- Versions with **vortex impeller** suitable for:
  - clean water, effluent, sewage containing suspended solids and fibres but non-faecal wastewater.
- Versions with **single or twin channel impeller** suitable for:
  - clean water, effluent, sewage not containing suspended fibres and faecal wastewater.

- **Midibox** can be installed on the floor or buried in a suitable structure following instructions in the "Instructions and Operative Manual".
- **Easy installation**:
  - installation is quick and easy: for the single-phase versions you just connect the pipes and the electrical cables; for the three-phase versions you also need to connect the control panel.
  - The new **Midibox** is provided with side handles for ease of handling.
  - Pre-installed delivery pump and unions.
- **Ecological solution**:
  - tank made from 100% recyclable polyethylene.
- **Easy maintenance and repair**.
  - Tried and tested pump technology.
  - Pump quick and easy to remove thanks to the ring nut located near the cover.

**ACCESSORIES**

- Available accessories:
  - Ball check valves.
  - Alarm kit.
  - Connector kit.
  - Manual pump.

**IDENTIFICATION CODE**

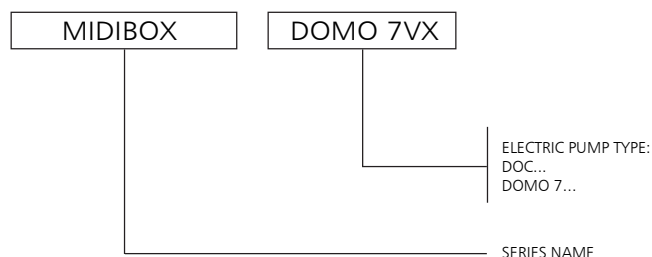

EXAMPLE : MIDIBOX DOMO 7VX  
Lifting station MIDIBOX series with DOMO 7VX submersible electric pump.

## MIDIBOX SERIES OPERATING CHARACTERISTICS AT 50 Hz

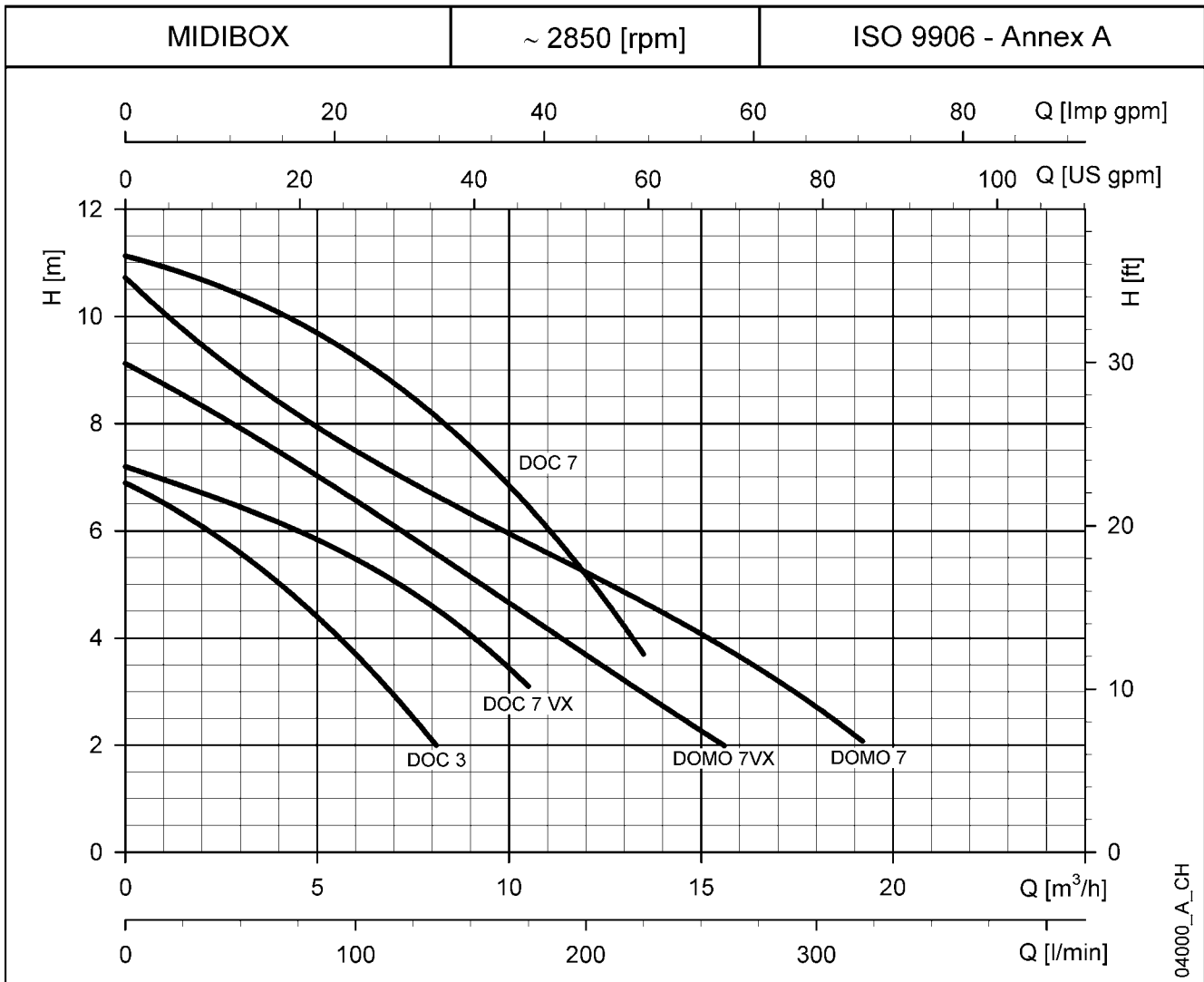

### HYDRAULIC PERFORMANCE TABLE

PUMP TYPE	RATED POWER		Q = DELIVERY									
			l/min	0	30	60	90	135	175	225	260	320
			m³/h	0	1,8	3,6	5,4	8,1	10,5	13,5	15,6	19,2
	kW	HP	H = TOTAL HEAD METRES COLUMN OF WATER									
DOC 3	0,25	0,33	6,9	6,2	5,3	4,1	2,0					
DOC 7(T)	0,55	0,75	11,1	10,7	10,2	9,5	8,1	6,5	3,7			
DOC 7VX(T)	0,55	0,75	7,2	6,8	6,3	5,7	4,5	3,1				
DOMO 7(T)	0,55	0,75	10,7	9,6	8,6	7,8	6,7	5,8	4,7	3,8	2,1	
DOMO 7VX(T)	0,55	0,75	9,1	8,4	7,7	6,8	5,6	4,4	3,0	2,0		

These performances (referred to the single pump) are valid for liquids with density  $\rho = 1,0 \text{ kg/dm}^3$  and kinematic viscosity  $\nu = 1 \text{ mm}^2/\text{s}$ .

midibox-2p50-en\_a\_th

### ELECTRICAL DATA TABLE

PUMP TYPE	ABSORBED POWER*	ABSORBED CURRENT*	CAPACITOR
	SINGLE-PHASE	220-240 V	$\mu\text{F} / 450 \text{ V}$
	kW	A	
DOC 3	0,31	1,43	6,3
DOC 7	0,78	3,47	16
DOC 7VX	0,66	2,96	16
DOMO 7	0,8	3,94	16
DOMO 7VX	0,79	3,91	16

PUMP TYPE	ABSORBED POWER*	ABSORBED CURRENT*	ABSORBED CURRENT*
	THREE-PHASE	220-240 V	380-415 V
	kW	A	A
-	-	-	-
DOC 7T	0,79	2,82	1,63
DOC 7VXT	0,66	2,68	1,55
DOMO 7T	0,73	2,58	1,49
DOMO 7VXT	0,71	2,56	1,48

\*Maximum values within operating range

midibox-2p50-en\_a\_te

**MIDIBOX SERIES**

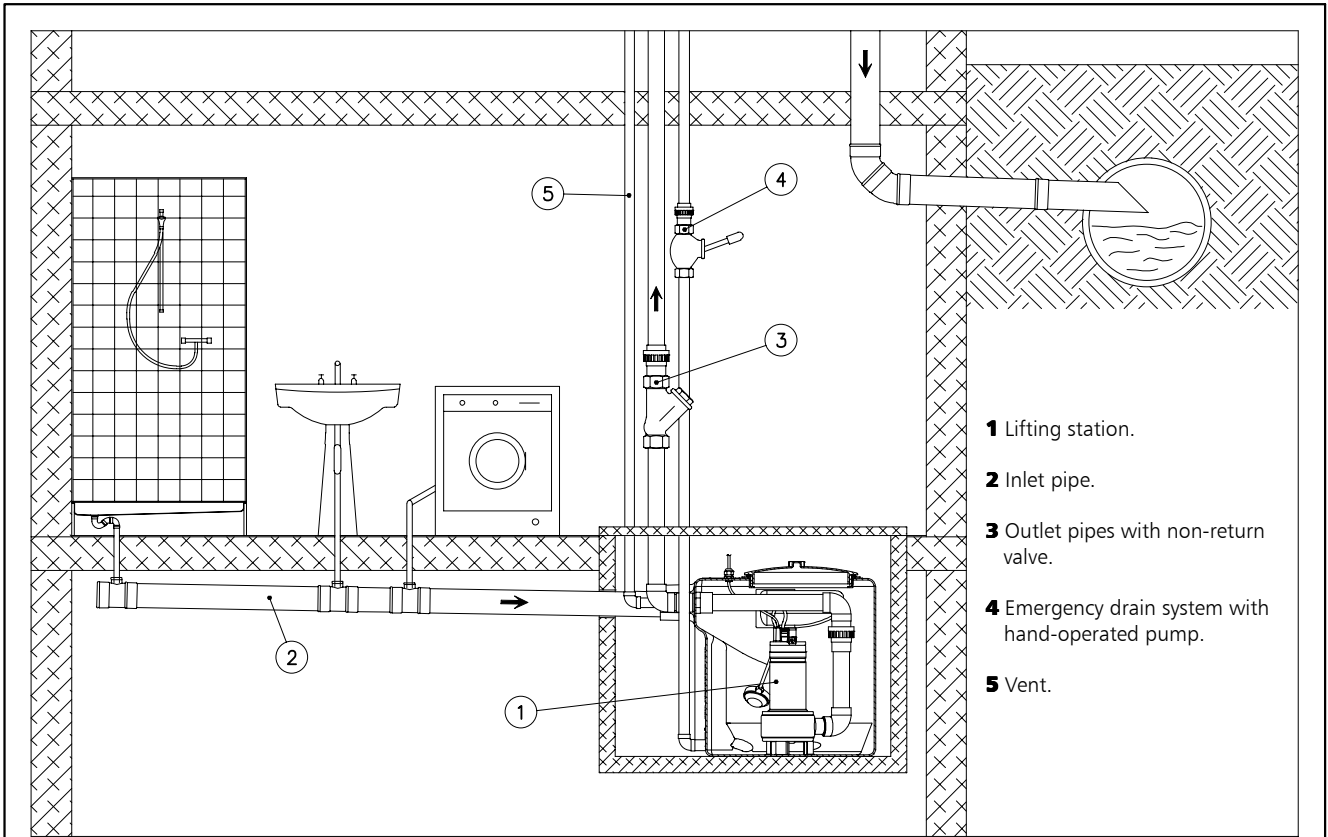

**DIMENSIONS AND WEIGHTS**

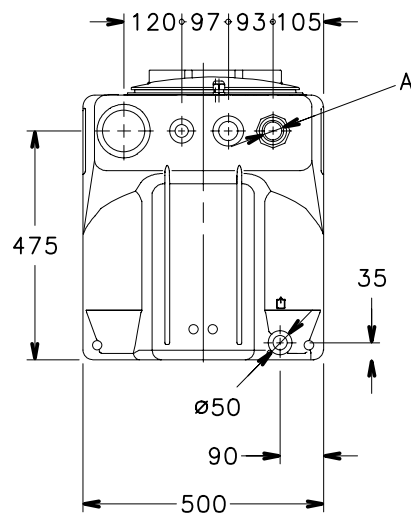
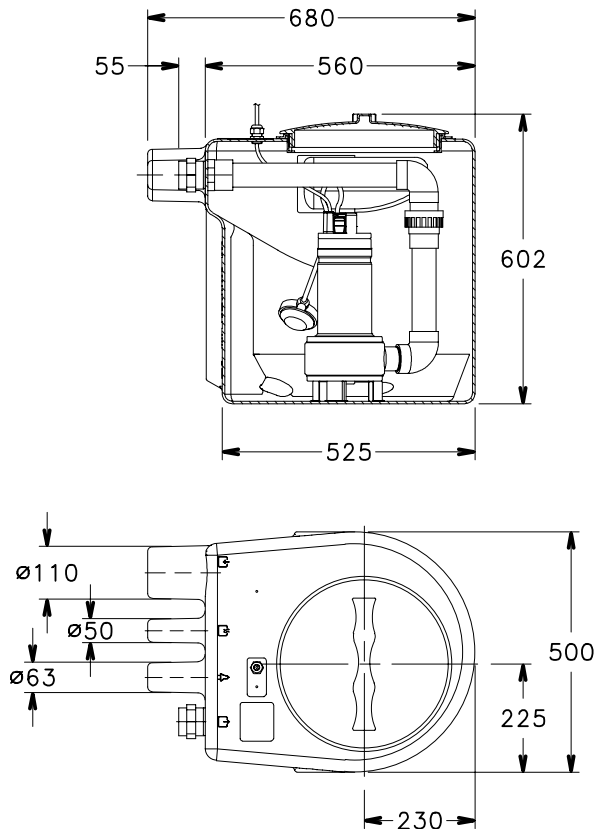

MODEL	DIMENSIONS (mm)		WEIGHT kg
	A		
MIDIBOX DOC3	Rp 1 1/4		13
MIDIBOX DOC7(T)	Rp 1 1/4		16
MIDIBOX DOC7VX(T)	Rp 1 1/4		16
MIDIBOX DOMO7(T)	Rp 1 1/2		20
MIDIBOX DOMO7VX(T)	Rp 1 1/2		20

04000\_A\_SC

midibox-en\_b\_td

**MIDIBOX SERIES  
APPLICATION EXAMPLES**

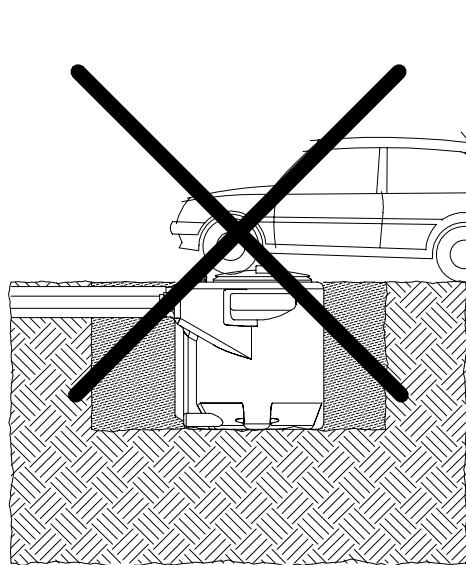
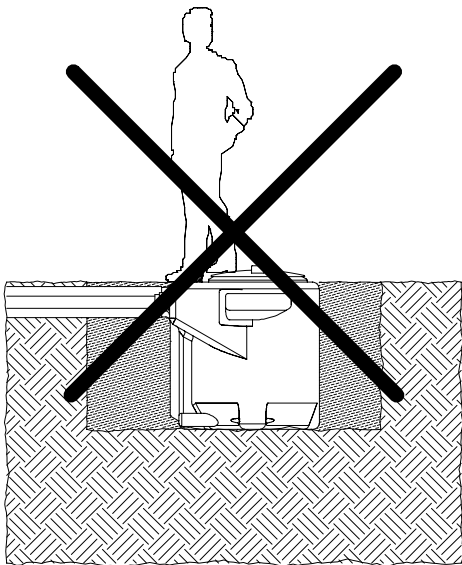
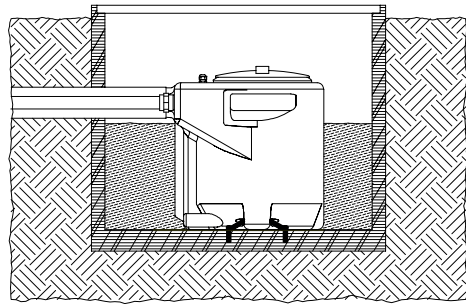
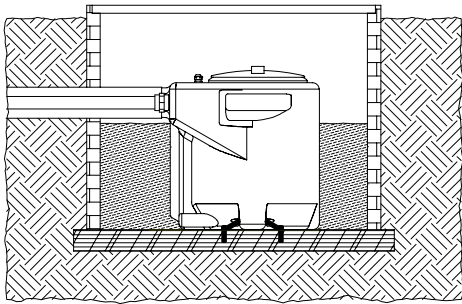
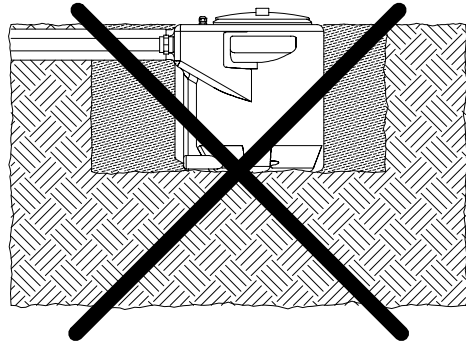
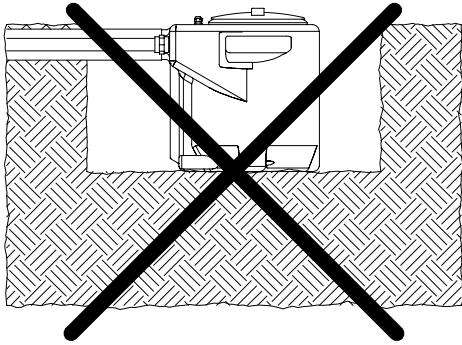

04003\_o\_sc